

Costa Mesa Bead & Design Show

April 13 - 15



DAVID FREELAND JR

**Hilton
Costa Mesa
3050 Bristol St**

**ARTISANS &
WORKSHOPS**

**BEADS • GEMS • CLOTHING • JEWELRY
MINERALS • RESOURCES • ANTIQUITIES**

10am - 6pm • Advance tickets \$8 (\$10 at the door)

BEADANDDESIGN.COM

GEMSTONES & SILVER 224-226
 GODDESS EMERALD BAY 2



Goddess
 7206 Melrose
 Los Angeles, CA 90046
 info@RealmOfTheGoddess.com
 323-525-1002

LEILANI ARTS	272
LEXI STAURING	136
LUISA RUIZ	217
MARIANO GEMS	217
METAL WORKING DEMOS	256-257
MODA LUCIDO	202
NATURAL STONE FINE ART	142
NOMADIC TEXTILES	275
PAMELA LEE	205
PEARL CREATIONS	104
PEMA ARTS	211-213
PENARI ART	128-127
PURPLE DOOR STUDIO	BALBOA RM 3
QQ GEMS	107-109 & 119-121
REALM OF THE GODDESS	115
ROYAL INTERNATIONAL	277
SADCO INC	203
SAHIL GEMS & JEWELRY	271
SCHWEIZ GROUP	274
SJ PEARL	282
STARLIGHT GEMS	208
STONE PEARL CREATION	103-102
STONE TOWN	117
STONECUTTERS	233
STRING BEAD	266-267
SUNLIGHT GEMS	209-210
THE BAKELITE LADY	205
THE LILLIAN TODARO COLL	110
TIBETAN ARTS	211
TOOL & SUPPLY	BALBOA 2
VINTAGE BEADS	275
WENDY MASTERSON	219
WEST LOVE	206
WINGO TRADING	199-201
YONGJIA CO.	241

H.E. TUNKARA & BEADS	218
HANDMADE DESIGN	245
HANDTOOLED LEATHER	278
HIMALAYAN ESSENTIALS	235-237
INEZ FLAUGH	BALBOA 3
JAZZY D CREATIONS	204
JENNIFER CHEN	123
JENNIFER GEMS	EMERALD BAY 3
JEWEL PLEDGE	131-133 & 116-117
JEWELLENNIUM	216
JEWELRY DESIGNS	254
JM BEADS & FINDINGS	214-215
JOSIE WOOD ATELIER	106
LA SOURCE GEMS	134
LARIMA CA	217
LAURA MOORE	111
LE PLUME STUDIOS	262-263
LEATHER & CHAIN ORIGINALS	281

FRIDAY, 13TH

SPRUCED UP FINE SILVER PENDANT
CAT BURTON 9AM - 1PM
FEES: \$110 BALBOA ROOM 3

**EARRINGS OF ELEGANCE,
FINE SILVER**
BRENNA JIMENEZ 9AM - 1PM
FEES: \$110 BALBOA ROOM 3

MINI-INTRO MAKE & TAKE
ART CLAY INSTRUCTORS 10AM - 11AM
FEES: \$20 BOOTH #126

MINI-INTRO MAKE & TAKE
ART CLAY INSTRUCTORS 12PM - 1PM
FEES: \$20 BOOTH #126

BEGINNING SOLDERING
CAROLE WITT 1PM - 5PM
FEES: \$79 BALBOA ROOM 2

MINI-INTRO MAKE & TAKE
ART CLAY INSTRUCTORS 2PM - 3PM
FEES: \$20 BOOTH #126

LAZY PEARL SPIRAL
LILLIAN TODARO 2PM - 5PM
FEES: \$50 KIT \$39 SEAL BEACH ROOM

**BRANCHING OUT FINE
SILVER PENDANT**
BRENNA JIMENEZ 2:30PM - 6:30PM
FEES: \$110 BALBOA ROOM 3

SHIELDED FINE SILVER PENDANT
INEZ FLAUGH 2:30PM - 6:30PM
FEES: \$100 BALBOA ROOM 3

TUBE SETTING - SOLDERING
CAROLE WITT 6PM - 9PM
FEES: \$79 BALBOA ROOM 2

SATURDAY, 14TH

**WRAPPED AROUND YOU LEATHER
AND FINE SILVER BRACELET**
BRENNA JIMENEZ 9AM - 1PM
FEES: \$100 BALBOA ROOM 3

**RING AROUND THE ROSES
FINE SILVER RING**
INEZ FLAUGH 9AM - 1PM
FEES: \$100 BALBOA ROOM 3

MINI-INTRO MAKE & TAKE
ART CLAY INSTRUCTORS 10AM - 11AM
FEES: \$20 BOOTH #126

MINI-INTRO MAKE & TAKE
ART CLAY INSTRUCTORS 12PM - 1PM
FEES: \$20 BALBOA ROOM 3

MINI-INTRO MAKE & TAKE
ART CLAY INSTRUCTORS 2PM - 3PM
FEES: \$20 BOOTH #126

BLACK HEARTS NECKLACE
LILLIAN TODARO 2PM - 5PM
FEES: \$40 KIT \$39 SEAL BEACH ROOM

**BUBBLING BEAUTY
FINE SILVER PENDANT**
CAT BURTON 2PM - 8PM
FEES: \$150 BALBOA ROOM 3

**SECRETS OF THE HEART FINE
SILVER EARRINGS**
BRENNA JIMENEZ 2PM - 8PM
FEES: \$140 BALBOA ROOM 3

**IN-DEPTH ETCHED/CHAMPLEVE
ENAMELING WORKSHOP**
CAROLE WITT 2PM - 9PM
FEES: \$158 BALBOA ROOM 2

SUNDAY, 15TH

**NATURAL TENDENCIES FINE
SILVER PENDANT**
CAT BURTON 8:30AM - 12:30PM
FEES: \$120 BALBOA ROOM 3

**NATURE FRAMED FINE SILVER
PENDANT**
INEZ FLAUGH 8:30AM - 12:30PM
FEES: \$120 BALBOA ROOM 3

MINI-INTRO MAKE & TAKE
ART CLAY INSTRUCTORS 10AM - 11AM
FEES: \$20 BOOTH #126

MINI-INTRO MAKE & TAKE
ART CLAY INSTRUCTORS 12PM - 1PM
FEES: \$20 BOOTH #126

MINI-INTRO MAKE & TAKE
ART CLAY INSTRUCTORS 2PM - 3PM
FEES: \$20 BOOTH #126

CRYSTAL CATERPILLAR
LILLIAN TODARO 2PM - 5PM
FEES: \$40 KIT \$39 SEAL BEACH ROOM

**BOUNTIFUL BOUQUET FINE
SILVER PENDANT**
INEZ FLAUGH 2PM - 6PM
FEES: \$100 BALBOA ROOM 3

LUNA LAYERED SILVER PENDANT
CAT BURTON 2PM - 6PM
FEES: \$115 BALBOA ROOM 3



*Wrapped Around You
Leather Silver Bracelet*



*In-depth
Etched
Enamel*



*Shielded
Fine Silver Pendant*



*Crystal
Caterpillar*



*Secrets of the Heart
Fine Silver Earrings*

SEAL BEACH ROOM
UPPER LEVEL

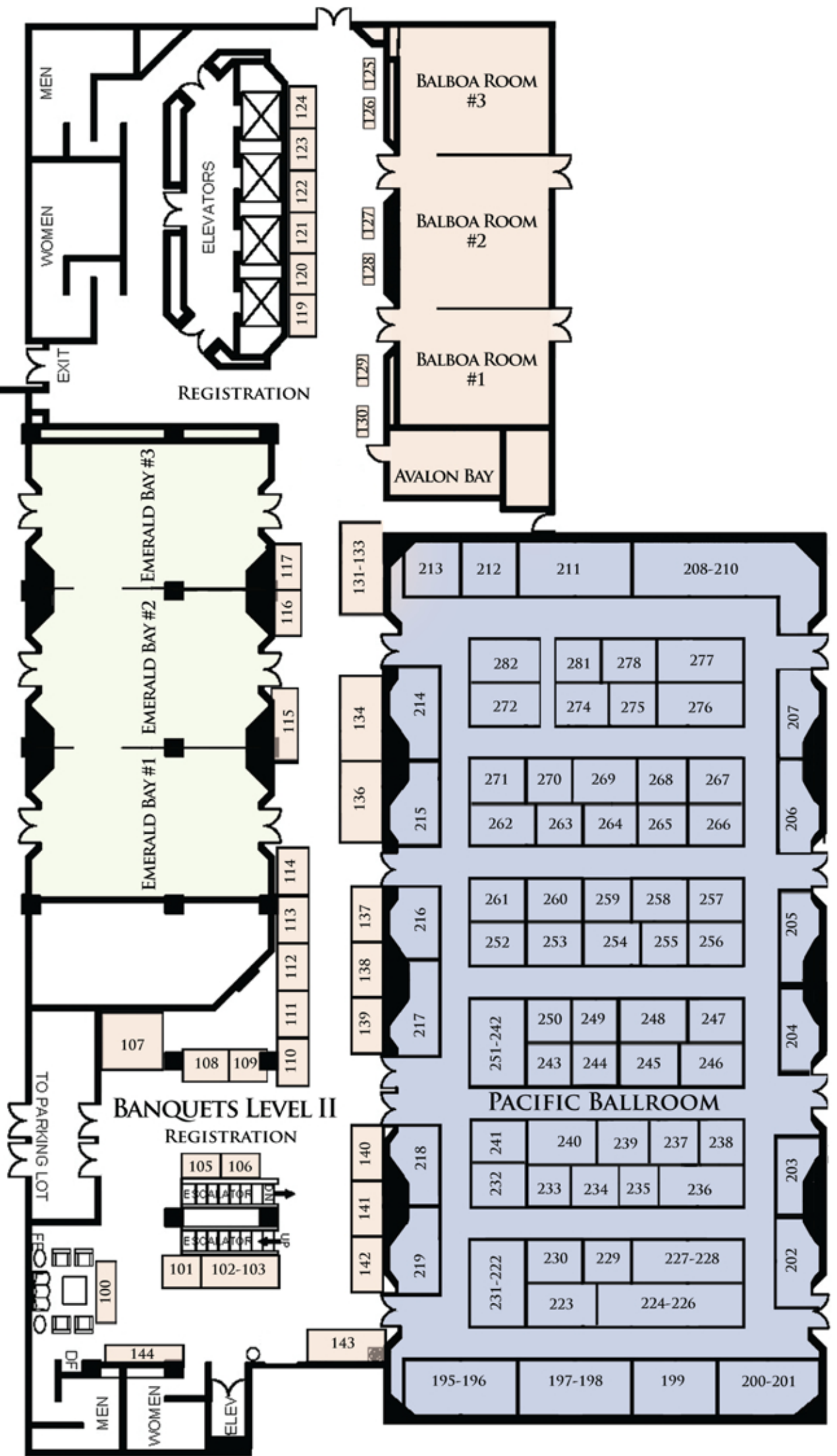

ONGOING FREE DEMOS AND CLASSES

BEADWORK CLASSES

WITH LILLIAN TODARO - BOOTH #110

ONGOING FREE DEMOS IN JEWELRY MAKING

BASIC JEWELRY MAKING INSTRUCTION

WITH CAROLE WITT - BALBOA ROOM #2

ONGOING FREE DEMOS IN JEWELRY MAKING INCLUDING
STRINGING, CRIMPING, AND JEWELRY TOOL INSTRUCTION

ARTCLAY DEMONSTRATIONS

ART CLAY INSTRUCTORS - BALBOA ROOM #3

DAILY DEMONSTRATIONS OF HOW TO USE ARTCLAY TO CREATE
PURE SILVER JEWELRY

GARDEN OF BEADIN JEWELRY MAKING ADVICE

GARDEN OF BEADIN - EMERALD ROOM

NEED HELP WITH BEADWORK ADVICE, COME ASK
AT GARDEN OF BEADIN!

METAL WORKING DEMOS

WITH STRING BEAD - BOOTH #206

ONGOING FREE DEMOS IN METAL WORKING AND
JEWELRY TOOLS!



INFO@BEADAGIO.COM ~ 530-274-2222

BEADANDDESIGN.COM