



BEAD & DESIGN
SHOWS

Pasadena

Costa Mesa

Santa Clara

Tucson



TERRY HENRY

Pasadena Bead & Design Show

JANUARY 12 - 15

Hilton Pasadena

168 S. Los Robles Ave, Pasadena CA

ARTISAN BOOTHS, GALLERIES & WORKSHOPS

BEADS • GEMS • CLOTHING • JEWELRY • ANTIQUITIES
RESOURCES • FINDINGS • VINTAGE • ARTS & CRAFTS

10am - 6pm Daily • \$10 Admission - Good for All Days • Open to the Public

BEADANDDESIGN.COM

EXHIBITORS



gardenofbeadin.com
 Located in
Santa Barbara Room

Make Crimping Easy!

with the *Om Tara* Crimping Pliers



At Booth I161

Om Tara



Merilou
 Wire Wrapping, Dichroic Glass
Jewelry
 California Room

AFRICAN GEMS	SANTA ROSA RM-P271	DESIREE CHOW	A1
AFRICAN IMPORTS		I133 DESPINA BUONCRISTIANI	PASADENA #1
ALCIA M. DUNWOODY	G247	DEVOCEANBLUE JEWELRY	G247
ALLEN'S BEADS	I152	DEWA	A2
ALOHA PEARLS, INC.	P255	DIANA MARCH	G242
AMBER FRIGAARD	G228	DIANE WHITING	MONTEREY RM
AMULETE GEMS INC	1126-127	DICHOIC INC	C215
AMY LOH KUPSER	I134	DOTERRA ESSENTIAL OILS	I132
ANANTARA	I141	DRESSED TO KILL	G232
ANCIENT DESIGN	C181	EAST WEST BEST TRADING CO	I155
ANDIE COHEN-HEALY	C196	ELAINE SONNE	C181
ANDREE BENATAR	I174	ELLE OF CALIFORNIA	G230
ANDS SILVER LLC	P264	ERIKA HARRIS	G230
ANN N EVE COLLECTION	C183	ERIKO PAGE	A13B
ANNA KONYA DESIGNS	G227 & 228	ETHOS	G233
ANTIQUÉ TEXTILES	C192-191	EXIM BEADS	I116-118
ART CLAY WORLD, USA	PASADENA #1	FAIRE WIND FASHION	G243
ARTRADE	I111	FARM FRESH TO YOU	A14
ARTWORKS BY CATHY J.	I113	FILIGREE AND ME	I113
ATALIA MOLARO	SAN MARINO RM		
BARBARA GARWOOD	G244		
BEAD ART WORTH	A5B		
BEAD BAZAAR	I164		
BEAD BISTRO	I119		
BEAD PALACE	PASADENA #1		
BEAD RESOURCES CORP	DEL MAR		
BEADED STATEMENTS BY LICIA	C207		
BEADS AND ETC	A19		
BEADS AT BEADS, INC	I102-103	FOREST JEWELRY	I172
BEADS BY SANDY	G239	FOREVER SILVERS	I112
BEADS CREATION	P252 & PASADENA RM	FOXES AND ROBBERS	A1
BEADS ON MAIN	I120	FU CHEUNG	A9
BEADS U NEED	SANTA CLARA RM	GARDEN OF BEADIN'	SANTA BARBARA RM
BEADSHAPER	A5	GARG GEMS	PASADENA #1
BEAUTY AND THE BEADS	SANTA MONICA	GEMBOX CREATIONS	A8
BETTY JANE'S CREATIONS	A6	GEMINI GEMS	C203
BEYOND BEADS GALLERY	A5B		
BILLY'S A BAD KITTY	A4		
BISTRO CRAFTS	I119		
BRUNA FERRARI BEAD	I124-125		
CAROL FONDA-CLARK	C215		
CAROLE WITT	SAN MARINO RM		
CASSANOVA'S JEWELRY	C204		
CATHY BURTON	PASADENA #1		
CAZ KNITWEAR	G232		
CHARLOTTE SILVERSTEIN	SANTA BARBARA RM	GEMSTONES OF AFRICA	P271-272
CLAUDIA GRAU	A3	GEORGINA BROWN	PASADENA #1
CONCEPCION	C194	GILROY GORRE	I159
CREATWEEGO	C210	GODDESS	I167
CROSSROADS ARTS COLLECTIVE	A3	GRAU DESIGNS	A3
DANSKER DESIGNS JEWELRY	C182	GYPSY PHOENIX FLAME PAINTED COPPER	C197
DANSKER DESIGNS SKIN & BODY CARE	C182	H.E. TUNKARA & BEADS	G224
DAVID KUO	A11	HANDFAST DESIGN	I150
DEBORAH STAEHLE	SANTA BARBARA RM	HEALING STONES JEWELRY	C181
DESIGN IMPORTS	C205-206	HEART & HAND	A13B
		HEAVENLY TOFFEE	A10
		HWY. 1 JEWELRY DESIGN	A4
		I-BEAD.COM	I134
		INEZ FLAUGH	PASADENA #1
		IRMA FLORES	G233
		JACKIE JONES COLLECTION	G229
		JANE BIRD	C205-206
		JANE MOHR DESIGNS	G232
		JANU GEMS	P259-260
		JAZZY D CREATIONS	FRONT LOBBY
		JENNIFER CHEN	P268

Filigree & Me

Cathy Jones
 503.779.9788
 cjones134@cox.net
 www.filigreeandme.com

Gemini gems

Custom cut matched pairs, Designer beads and briolette,
 Bezel set gemstones, Gemstone wire wrap chains
 Geminigemsheads@gmail.com 925-577-5164

DESIGN IMPORTS
 FINE TAXCO SILVER JEWELRY

Pasadena Bead and Design Show
 Pasadena Hilton
 168 S. Los Robles Avenue
 California Ballroom, Booth No. 205-206

If lost, please call Jane at:
 (626) 864-7724

Thursday-Sunday: 10 am - 6 pm
 Credit Cards Welcome!

EXHIBITORS

JENNIFER GEMS	P266-267 & SAN MARINO	PALM OF HOPE JEWELRY DESIGNS	C209
JENNIFER OSNER	C192-191	PATRICIA HEALEY	I149
JEWELRY BY DENISE	LOBBY	PEMA ARTS	1105-106
JEWELRY BY KIA	C198	PLANET CHIC IMPORTS	G225
JEWEL PLEDGE	P261 & 258	PURE INTENT	I107
JEWELS OF THE EARTH	G242	QQ BEADS	SACRAMENTO RM
JM BEADS & FINDINGS	SAN JOSE RM	REALM OF THE GODDESS	I167
JODY YOUNG	A5B	ROBERT LOPEZ DESIGNS	A4
JOSEPH ZAPF-KENT	C186	ROSE KLAPMAN	A5
JOSIE WOOD ATELIER	LOBBY	ROYAL INTERNATIONAL ENT.	P257
JUDIE MOUNTAIN	C190	SAMSTONE, INC	I174
KAREN GATCHELL	C209	SANDY SCHOR AND CO	G239
KARMA	I100	SARAH GALEMMO	G243
KATHMANDU JEWELRY	I100	SAVANNAH DESIGNS	A13
KATIE BAUM	PASADENA #1	SCOTTSDALE BEAD SUPPLY	A12
KIM FOX	I150	SEW SILLY HATS	C208
KIM WILLIAMS	I107	SHELL LA VIE	I159
KLEWS GALLERY	C179	SILVER EGYPT	G234
KUNSANG LAMA	A2	SJ PEARL	I128
KUO'S JEWELRY	A11	STONE PEARL CREATION INC	A16
LA SOURCE GEMS	I157	STONE TOWN	P261 & 258
LAURA GASPARRINI	I161	STRING BEAD	SAN MARINO RM
LAURA MOORE	A4	SURREALIST USA	G245
LAUREN ANDERSON	A6	SUZI CLICK	A3
LAURIE'S NATURALS	A5C	SYMONE BEASLEY	SAN MARINO RM
LESLIE HAMILTON	I145-147	TAKASHIMA JEWELERS	C184
LICIA RAMOS	C207	TAMARA WARD	G245
LILLIAN TODARO COLLECTION	G247	TANGIBLE LIGHT STUDIO	A7
LOCO LINDO	C180	TERRY HENRY GLASSWORKS	A4
M.S. INTERNATIONAL	C213-214	THE BEAD GOES ON	I138
MALOU SADIUA-OBALEK	A8	THE CHAINMAILLE LADY	A6
MANUSH TERMARTIROSYAN	MONTEREY RM	THE FEATHERED HEAD	C196
MARY AYRES	G225	THE GOOD MEDICINE SHOP	C186
MERILOU JENKINS	C201-202	THE PERFECT GEM	I115
MICHELLE CAMERON	G223		
MICHELLE DAVIS	A7		
MICHELLE MARCHIANO	SAN MARINO RM		
MIKE CHARVEAUX	A12		
MINERALS & GEMS	I143		
MIRIAM STARK	C197		
MONTY CLARK	C215		
MOUNTAIN & ROBBINS	C190		
NANCY WRIGHT DESIGNS	A18		
NIMAGA IMPORT	I133		
ODIE'S BEAD-IT	I163		
OLD WORLD BRONZE	A12		

Located in Booth I167

Goddess

7206 Melrose
Los Angeles, CA 90046
info@RealmOfTheGoddess.com
323-525-1002

Items shown include: Rose Gold Goggles, N-94, B-103, Sugar Maple, ST-17 Sliced Amethyst Stalactite, ST-13 Black Onyx, ST-18 Blue Chondroly Grusy, ST-14 Red Coral Ball, ST-19 Turquoise, CP-2, CP-1.

The Perfect Gem

Booth # I115
International Ballroom

Showroom:
9507 Harwin Dr.,
Suite # 135
Houston, TX
77036

www.ThePerfectGem.com
"Mother Earth's Best Gifts"

THERRI'S TREASURES	C188
TILA & THE TEXTILES	G228
TREASURE JEWELRY DESIGN	I151
UNIQUE DESIGNS BY MERILOU	C201-202
URU CLOTHING	G223
WAYNE ROBBINS	C190
WENDY MASTERSON	I155
WEST LOVE	I133
WRISTY BUSINESS	1145-147
YONGJIA CO	I131

Old World Bronze

IN BOOTH A12

HAND CAST
SOLID BRONZE BEADS
COMPONENTS, JEWELRY
AND MORE.

480.945.5988 WWW.SCOTTSDALEBEAD.COM

OM TARA	I161
PACIFIC SILVERWORKS	A13
PAGEWOOD FARMS	A3

Pacific Silverworks
Savannah Design Studio

Visit Us for the very latest in designer components & jewelry!

Booth A13

PACIFIC SILVERWORKS
Savannah
savannahdesignstudio.com

WORKSHOPS

Thurs, 12th

BASIC PENDANT

MERILOU JENKINS 9AM - 1PM
FEES: \$85 KIT \$50 BOOTH C201

TREASURES OF THE SEA BRACELET COPPER ELECTROFORMING FOR ARTISTS & MAD SCIENTISTS

TERRY HENRY 9AM - 3:30PM
FEES: \$75 KIT \$75 MONTEREY ROOM

MAKE YOUR OWN FINDINGS

ATALIA MOLARO 10AM - 1PM
FEES: \$69 SAN MARINO ROOM

ELECTROPLATING

SYMONE BEASLEY 10AM - 1PM
FEES: \$69 SAN MARINO ROOM

PLANKED FINE SILVER PENDANT

DESPINA BUONCRISTIANI 10AM - 2PM
FEES: \$120 PASADENA ROOM #1

BEAD CROCHET NECKLACE

ROSE KLAPMAN 11AM - 1:30PM
FEES: \$70 KIT \$40 MONTEREY ROOM

MOONSHINE

JODY YOUNG 1PM - 4PM
FEES: \$40 KIT \$45 MONTEREY ROOM

KNOTTED LINEN GEMSTONE TASSEL NECKLACE

LAURA GASPARRINI 1:30PM - 4:30PM
FEES: \$75 TREVO'S RESTAURANT

SUPER EASY PEASY CHAINMAILLE EARRINGS!

LAUREN ANDERSON 2PM - 4PM
FEES: \$5 TREVO'S RESTAURANT

STACKABLES

MICHELLE MARCHIANO 2PM - 5PM
FEES: \$69 SAN MARINO ROOM

BEAD KNOTTING

ROSE KLAPMAN 2PM - 5PM
FEES: \$50 KIT \$25 TREVO'S RESTAURANT

MICRO MOSAIC

CAROLE WITT 2PM - 5PM
FEES: \$69 SAN MARINO ROOM

CONTESSA II PENDANT

DIANE WHITING 2PM - 6PM
FEES: \$35 KIT \$28 MONTEREY ROOM

GEMSTONE DONUT

MERILOU JENKINS 2PM - 6PM
FEES: \$85 KIT \$50 BOOTH C201

FUN AND CUTE BUTTON EARRINGS

LAURA MOORE 3PM - 6PM
FEES: \$69 KIT \$25
MONTEREY ROOM

FEATHERED FRIEND

CATHY BURTON 3PM - 7PM
FEES: \$110 PASADENA ROOM #1

SOFT SOLDERING

ATALIA MOLARO 6PM - 9PM
FEES: \$79 SAN MARINO ROOM

HOW TO FINISH METAL

CAROLE WITT 6PM - 9PM
FEES: \$69 SAN MARINO ROOM

BEGINNING TORCH SOLDERING

MICHELLE MARCHIANO 6PM - 9:30PM
FEES: \$69 SAN MARINO ROOM

Fri, 13th

TWIST & SHOUT PENDANT

GEORGINA BROWN 9AM - 12PM
FEES: \$99 PASADENA ROOM #1

ELEGANT PATTERN WIRE BRACELET

MERILOU JENKINS 9AM - 1PM
FEES: \$85 KIT \$50 BOOTH C201

DOWNTOWN LIGHTS CONVERTIBLE NECKLACE/ BRACELET

DIANE WHITING 10AM - 1PM
FEES: \$25 KIT \$25
MONTEREY ROOM

VIOLA BRACELET

MANUSH TERMARTIROSYAN 10AM - 1PM
FEES: \$70 TREVO'S RESTAURANT

INTERMEDIATE RIVETING

ATALIA MOLARO 10AM - 1PM
FEES: \$69 SAN MARINO ROOM

Ring Around The Roses



Silk Scarves



WORKSHOPS

EAR CUFFS AND CLIMBERS

MICHELLE MARCHIANO 10AM - 1PM
FEES: \$69 SAN MARINO ROOM

UNDER THE SEA RAISED TEXTURE PENDANT

JODY YOUNG 10AM - 5PM
FEES: \$100 KIT \$75 MONTEREY ROOM

ETCHING

ROSE KLAPMAN 11AM - 2PM
FEES: \$80 MONTEREY ROOM

TUSSIE MUSSIE GLASS BROOCH

TERRY HENRY 12PM - 5PM
FEE \$62 KIT \$55 MONTEREY ROOM

VICTORIAN LACE EARRINGS

INEZ FLAUGH 12:30PM - 4:30PM
FEE \$120 PASADENA ROOM #1

INTERCHANGEABLE FRENCH TASSELS

DIANE WHITING 1:30PM - 4:30PM
FEES: \$30 KIT \$27 MONTEREY ROOM

KNOTTED PEARL AND LEATHER TASSEL NECKLACE

LAURA GASPARRINI 1:30PM - 4:30PM
FEES: \$75 TREVO'S RESTAURANT

SUPER EASY PEASY CHAINMAILLE EARRINGS!

LAUREN ANDERSON 2PM - 4PM
FEES: \$5 TREVO'S RESTAURANT

TORCH ENAMELING

ATALIA MOLARO 2PM - 5PM
FEES: \$69 SAN MARINO ROOM

PRONG SETTING

CAROLE WITT 2PM - 5PM
FEES: \$69 SAN MARINO ROOM

DD PENDANT

MERILOU JENKINS 2PM - 6PM
FEES: \$85 KIT \$50 BOOTH C201

VIKING KNIT BRACELET

ROSE KLAPMAN 2:30PM - 5PM
FEES: \$70 KIT \$50 MONTEREY ROOM

ALWAYS IN MY HEART

LENTIL PENDANT

ESPIE BUONCRISTIANI 5PM - 8:30PM
FEES: \$99 PASADENA ROOM #1

RHINESTONE JEWELRY

CAROLE WITT 6PM - 9PM
FEES: \$69 SAN MARINO ROOM

ORGANIC METAL PATINAS

MICHELLE MARCHIANO 6PM - 9PM
FEES: \$69 SAN MARINO ROOM

KUMIHIMO/MAGNETIC BRACELET

KIM FOX 6PM - 9PM
FEES: \$65 MONTEREY ROOM

ENAMELED FLOWERS

ATALIA MOLARO 6PM - 9PM
FEES: \$69 SAN MARINO ROOM

Sat, 14th

FIVE BEAD BANGLE

MERILOU JENKINS 9AM - 1PM
FEES: \$85 KIT \$50 BOOTH C201

BUBBLING BEAUTY

CATHY BURTON 9AM - 1PM
FEES: \$120 PASADENA ROOM #1

WOODLAND FAIRY BRACELET COPPER ELECTROFORMING FOR ARTISTS AND MAD SCIENTISTS

TERRY HENRY 9AM - 3:30PM
FEES: \$75 KIT \$75 MONTEREY ROOM

ETCHING

SYMONE BEASLEY 10AM - 1PM
FEES: \$69 SAN MARINO ROOM

SHELL SPIRAL BRACELET

DIANE WHITING 10AM - 1PM
FEES: \$35 KIT \$20 MONTEREY ROOM

KNOW YOUR SAW

ATALIA MOLARO 10AM - 1PM
FEES: \$69 SAN MARINO ROOM

POCKET FULL OF POSIES PENDANT

JODY YOUNG 10AM - 5PM
FEES: \$100 KIT \$95 MONTEREY ROOM

VIKING KNIT LEATHER BRACELET

ROSE KLAPMAN 11AM - 2PM
FEES: \$70 KIT \$50 MONTEREY ROOM



Shell Spiral Bracelet



WORKSHOPS

WORKING WITH LEATHER – MACRAMÉ BRACELETS!

LAURA GASPARRINI 1:30PM - 4:30PM
FEES: \$75 TREVO'S RESTAURANT

VERSATILE FINE SILVER NECKLACE AND EARRING SET

DESPINA BUONCRISTIANI 1:30PM - 5:30PM
FEES: \$120
PASADENA ROOM #1

SUPER EASY PEASY CHAINMAILLE EARRINGS!

LAUREN ANDERSON 2PM - 4PM
FEES: \$5 TREVO'S RESTAURANT

PEARL KNOTTING

SYMONE BEASLEY 2PM - 5PM
FEES: \$69 SAN MARINO ROOM

VIOLA BRACELET

MANUSH TERMARTIROSYAN 2PM - 5PM
FEES: \$70 TREVO'S RESTAURANT

HIGH SOCIETY BRACELET

DIANE WHITING 2PM - 6PM
FEES: \$35 KIT \$35
MONTEREY ROOM

WIRE WRAP SWAROVSKI EARRINGS

MERILOU JENKINS 2PM - 6PM
FEES: \$85 KIT \$50 BOOTH C201

SOLDERING WORKSHOP (STONE SETTING)

CAROLE WITT 2PM - 9PM
FEES: \$158 SAN MARINO ROOM

BEAD CROCHET NECKLACE

ROSE KLAPMAN 2:30PM - 5PM
FEES: \$70 KIT \$40 MONTEREY ROOM

KNIGHT'S HONOR

GEORGINA BROWN 6PM - 9PM
FEES: \$99 PASADENA ROOM #1

PEARLS LAMPWORK & KUMIHIMO NECKLACE

KIM FOX 6PM - 9PM
FEES: \$105 MONTEREY ROOM

SILK SCARVES

MICHELLE MARCHIANO 6PM - 9PM
FEES: \$69 SAN MARINO ROOM

ELECTROPLATING

SYMONE BEASLEY 6PM - 9PM
FEES: \$69 SAN MARINO ROOM

Sun, 15th

CHILDHOOD MEMORIES

CATHY BURTON 9AM - 1PM
FEES: \$115
PASADENA ROOM #1

INTERMEDIATE SOLDERING

MICHELLE MARCHIANO 10AM - 1PM
FEES: \$69 SAN MARINO ROOM

FIBER-ART TEXTURAL BEADED BRACELET

JODY YOUNG 10AM - 5PM
FEES: \$100 KIT \$85
MONTEREY ROOM

VIKING KNIT LEATHER BRACELET

ROSE KLAPMAN 11AM - 2PM
FEES: \$75 KIT \$50
MONTEREY ROOM

BOTANICAL IMPRESSIONS IN SILVER CLAY

LAURA MOORE 11:30AM - 6:30PM
FEES: \$110 KIT \$25
MONTEREY ROOM

INTERCHANGEABLE FRENCH TASSELS

DIANE WHITING 1:30PM - 4:30PM
FEES: \$30 KIT \$27
MONTEREY ROOM

RING AROUND THE ROSES

INEZ FLAUGH 1:30PM - 5:30PM
FEES: \$110 PASADENA ROOM #1

SUPER EASY PEASY CHAINMAILLE EARRINGS!

LAUREN ANDERSON 2PM - 4PM
FEES: \$5 TREVO'S RESTAURANT

BEGINNING TORCH SOLDERING

CAROLE WITT 2PM - 5:30PM
FEES: \$69 SAN MARINO ROOM

Micro Mosaic

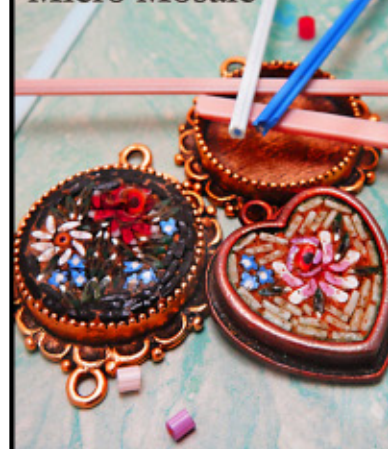

Planked Fine Silver Pendant



High Society Bracelet



FLOORPLAN

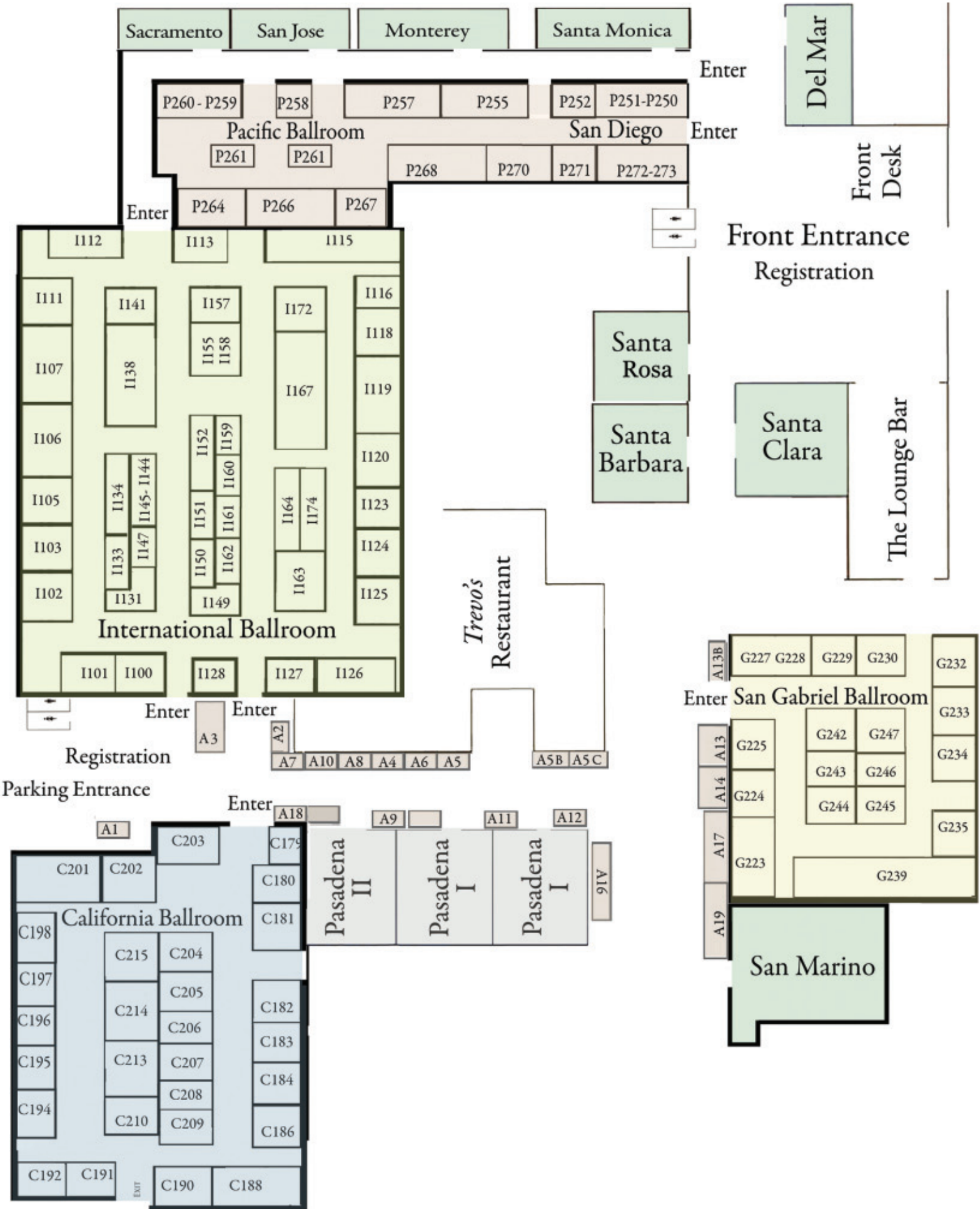

DEMOS

ONGOING DEMOS

ART CLAY SILVER DEMOS

ART CLAY WORLD -PASADENA ROOM

BEADWORK & BEAD WEAVING

GARDEN OF BEADIN - SANTA BARBARA ROOM

BEADING DEMOS

STRING BEAD - SAN MARINO ROOM

JEWELRY TOOL DEMOS

STRING BEAD - SAN MARINO ROOM

LILLIAN TODARO BEADWORK INSTRUCTION

LILLIAN TODARO -BOOTH #G247

OM TARA CRIMPING TECHNIQUES

LAURA GASPARRINI - BOOTH #I161

FREE MAKE & TAKE WITH ART CLAY WORLD: "SILVER CHARMS"

JAN 12 -15 · 11AM-12:00PM - A9

ART CLAY WORLD FREE MAKE & TAKE! ALSO TAKING PLACE AT 1PM, 3PM AND 5PM.

FREE DEMOS WITH STRING BEAD STAFF ONGOING – SAN MARINO ROOM

DAILY DEMONSTRATIONS OF HOW TO USE THE VINTAJ STAMP MACHINE AND OTHER JEWELRY TOOLS TO CREATE EARRINGS, METAL FINDINGS, PENDANTS AND MORE!

"SUPER EASY PEASY CHAINMAILLE EARRINGS!"

FROM 2-4PM DAILY – TREVO'S RESTAURANT - \$5

FOR ONLY \$5 LEARN TO MAKE THESE GORGEOUS CHAINMAILLE EARRINGS

WRISTY BUSINESS DEMOS!

LESLIE HAMILTON ONGOING - BOOTH #1147

DAILY DEMONSTRATIONS ON WIRE WRAPPING & BASIC JEWELRY MAKING TECHNIQUES!

BEAD & DESIGN
SHOWS



Pasadena
Costa Mesa
Santa Clara
Tucson

Costa Mesa Bead & Design Show

MARCH 17 - 19

Hilton Costa Mesa 3050 Bristol St, Costa Mesa CA

250 ARTISAN BOOTHS, GALLERIES & WORKSHOPS

BEADS • GEMS • CLOTHING • JEWELRY • RESOURCES • FINDINGS • VINTAGE

BEADANDDESIGN.COM